

Land Title Act 1994; Land Act 1994  
Form 21 Version 2

Sheet 1 of 17

**LATERAL ASPECT**  
Looking from the Southeast  
Not to Scale

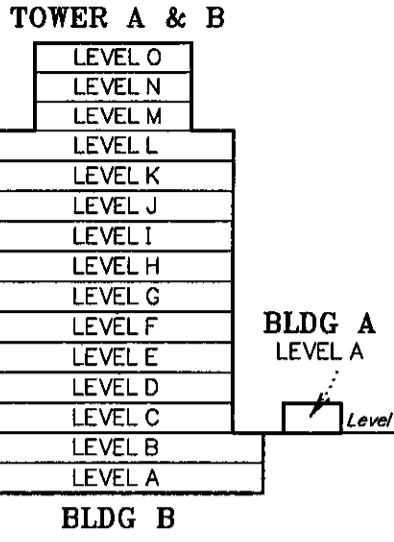

**SURVEY PLAN**

**DIAGRAM A**  
Scale 1:300



**TABLE A  
HWM TRAVERSE**

BEARING	DISTANCE
144°59'20" Orig	29.13 Orig
141°52' Orig	28.586 Orig
129°08' Orig	16.145 Orig

**BUILDING CONNECTIONS**

LINE	BEARING	DISTANCE
3-3a	6°04'30"	13.168
3-3b	20°45'	27.328
9-9a	216°09'	0.607
24-24a	128°47'	6.942
25-25a	32°51'20"	52.734
25-25b	32°59'	62.472

**PERMANENT MARKS**

PM	ORIGIN	BEARING	DIST	NO
3-OPM	3/1S161185	170°56'30"	36.09	26.073
12-OPM	12/1S161185	215°32'40"	51.521	37243
12-PM fd		205°34'50"	55.444	131361
24-PM		25°40'	1.607	167490

Gone

Lot 900 is a Standard Format Lot  
Original information compiled from RP68039 in the Department of Natural Resources and Water.  
**Area of Base Parcel**  
**5891 m<sup>2</sup>**

FOR REFERENCE MARKS SEE SHEET 2

Scale 1:800 - Lengths are in Metres.

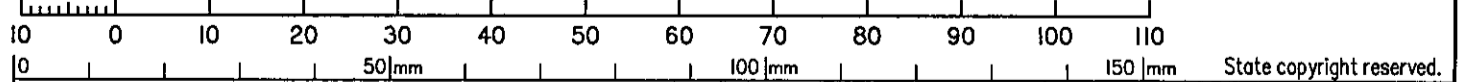

LandPartners Limited (ACN 118 146 008) hereby certify that the land comprised in this plan was surveyed by the corporation, by David WELLINGTON, cadastral surveyor for whose work the corporation accepts responsibility and that the plan is accurate, that the said survey was performed in accordance with the Survey and Mapping Infrastructure Act 2003 and Survey Act 2003 and associated Regulations and Standards and that the said survey was completed on 22/05/2007.

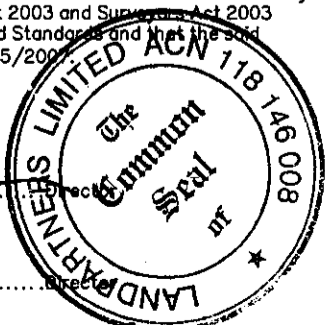

**Plan of Lots 900, 1011, 1021, 1022, 1031, 1032, 1041, 1042, 1051, 1052, 1061, 1062, 1071, 1072, 1081, 1082, 1091, 1092, 1101, 1111, 2011, 2021, 2022, 2031, 2032, 2041, 2042, 2051, 2052, 2061, 2062, 2071, 2072, 2081, 2082, 2091, 2092, 2101, 2111 & Common Property and Easements G, H & J in Common Property**  
Cancelling Lot 1 on RPI0961 & Lots 4-6 on RP68039  
PARISH: **SOUTH BRISBANE** COUNTY: **Stanley**

Scale: **1:800**  
Format: **BUILDING**  
  
**SP163172**  
Plan Status:

Meridian: **1S161185** F/N's: **No**

DL 1903-00-057 K 190300c4

710811896

\$2900.70

13/07/2007 15:50

BE 400 NT

WARNING : Folded or Mutilated Plans will not be accepted. Plans may be rolled. Information may not be placed in the outer margins.

Registered

5. Lodged by Wilkinson Lowry Lawyers Level 13, 175 Eagle Street Brisbane 4000 GPO Box 2033, Brisbane 4001 DX 152, Brisbane Ph: (07) 3002 6700 Fax: (07) 3002 6799

(Include address, phone number, reference, and Lodger Code)

1. Certificate of Registered Owners or Lessees. I/we SINCERE PROPERTIES (KANGAROO POINT) PTY LTD ACN 094 507 016 by its duly constituted attorney Geoff Alexander McFarlane under Power of Attorney dealing No 710590639

(Names in full)

\* as Registered Owners of this land agree to this plan and dedicate the Public Use Land as shown hereon in accordance with Section 50 of the Land Title Act 1994.

\* as Lessees of this land agree to this plan.

Signature of \*Registered Owners \*Lessees SINCERE PROPERTIES (KANGAROO POINT) PTY LTD ACN 094 507 016 by its duly constituted attorney Geoff Alexander McFarlane under Power of Attorney No 710590639

Dealing 601296742, Emt D on RP68039 is fully extinguished in lot 6 on RP 68039 Dealing 601851353, Emt D on RP68039 is fully extinguished in lot 6 on RP68039 Dealing 601851354, Emt E on RP68039 is fully extinguished in lot 6 on RP 68039 Dealing 601851356, Emt A on RP68039 is fully extinguished in lot 4 on RP68039 Dealing 601237305, Emt C on RP68039 is partially extinguished in lot 5 on RP68039 Dealing 601248533, Emts A, B & E on RP68039 are partially extinguished in lot 5 on RP68039 Dealing 601296741, Emt C on RP68039 is partially extinguished in lot 6 on RP68039, all in terms of s.87 LAND TITLES ACT 1994

Date 24/7/2007 Amendments by LAND PARTNERS LIMITED Director

\* Rule out whichever is inapplicable

2. Local Government Approval.

\* BRISBANE CITY COUNCIL

hereby approves this plan in accordance with the:

%

INTEGRATED PLANNING ACT 1997

Dated this 10th day of July, 2007

LESLIE HOWARD ACWORTH Appointed Officer

\* Insert the name of the Local Government. % Insert Integrated Planning Act 1997 or # Insert designation of signatory or delegation Local Government (Planning & Environment) Act 1990

3. Plans with Community Management Statement :

CMS Number : 37148 Name : CASTLEBAR COVE

4. References :

Dept File : Local Govt : Surveyor : BRDL1903.000

Table with columns: Existing (Title Reference, Lot, Plan) and Created (Lots, Emts, Road). Rows include 14886189, 12997194, 50122803, 13064009.

ENCUMBRANCE EASEMENT ALLOCATIONS

Table with columns: Easement, Lots to be Encumbered. Lists various easement numbers and their corresponding lots.

BENEFIT EASEMENT ALLOCATIONS

Table with columns: Easement, Lots Fully Benefited, Lots Partially Benefited. Lists easement numbers and the lots they benefit.

MORTGAGE ALLOCATIONS

Table with columns: Mortgage, Lots Fully Encumbered, Lots Partially Encumbered. Lists mortgage numbers and the lots they encumber.

Table with columns: 900, 1011, 1021, 1022, 1031, 1032, 1041, 1042, 1051, 1052, 1061, 1062, 1071, 1072, 1081, 1082, 1091, 1092, 1101, 1111, 2011, 2021, 2031, 2032, 2041, 2042, 2051, 2052, 2061, 2062, 2071, 2072, 2081, 2082, 2091, 2092, 2101 & 2111. Includes CP, ESA43, and Orig.

7. Portion Allocation :

8. Map Reference : 9543-33324

9. Locality : KANGAROO POINT

10. Local Government : BRISBANE CITY COUNCIL

11. Passed & Endorsed : By: LandPartners Limited Date: 24.5.2007 Signed: Liaison Officer

Development Approval: 30/09/2003

12. Building Format Plans ONLY I certify that: \* As far as it is practical to determine, no part of the building shown on this plan encroaches onto adjoining lots or roads; \* Part of the building shown on this plan encroaches onto adjoining lots and roads. Licensed Surveyor/Director

13. Lodgement Fees : Survey Deposit \$ Lodgement \$ New Titles \$ Photocopy \$ Postage \$ TOTAL \$

14. Insert Plan Number SP163172

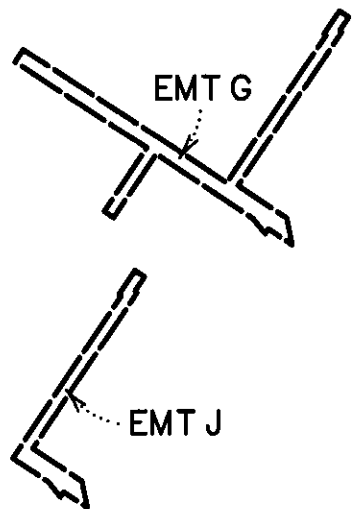

**DIAGRAM B**  
Scale 1:2000

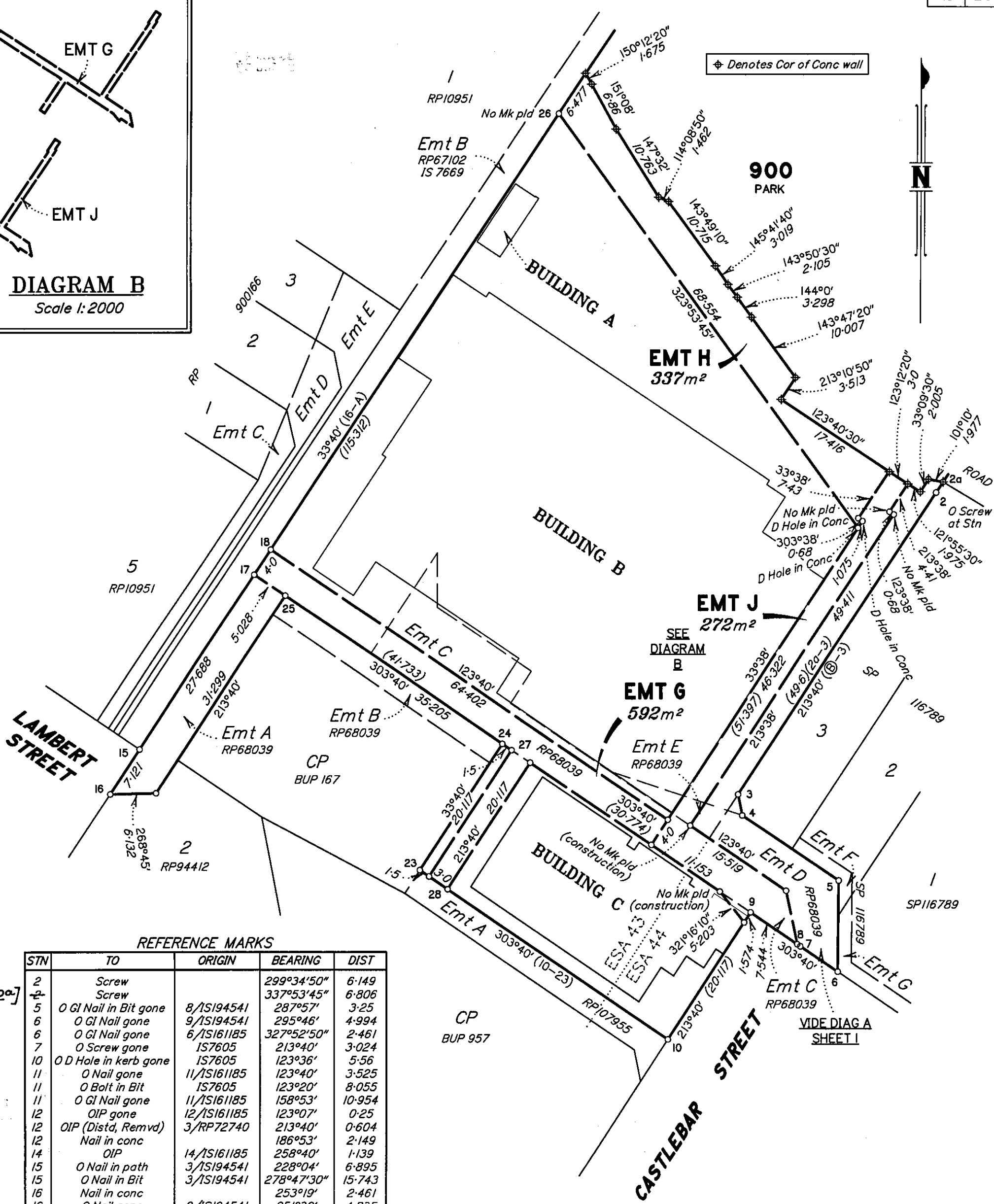

REFERENCE MARKS

STN	TO	ORIGIN	BEARING	DIST
2	Screw		299°34'50"	6-149
2	Screw		337°53'45"	6-806
5	O GI Nail in Bit gone	8/1S194541	287°57'	3-25
6	O GI Nail gone	9/1S194541	295°46'	4-994
6	O GI Nail gone	6/1S161185	327°52'50"	2-461
7	O Screw gone	1S7605	213°40'	3-024
10	O D Hole in kerb gone	1S7605	123°36'	5-56
11	O Nail gone	11/1S161185	123°40'	3-525
11	O Bolt in Bit	1S7605	123°20'	8-055
11	O GI Nail gone	11/1S161185	158°53'	10-954
12	OIP gone	12/1S161185	123°07'	0-25
12	OIP (Distd, Remvd)	3/RP72740	213°40'	0-604
12	Nail in conc		186°53'	2-149
14	OIP	14/1S161185	258°40'	1-139
15	O Nail in path	3/1S194541	228°04'	6-895
15	O Nail in Bit	3/1S194541	278°47'30"	15-743
16	Nail in conc		253°19'	2-461
16	O Nail gone	2/1S194541	251°30'	4-835
18	Screw in Conc		120°17'	18-052
24	O Bolt gone	7/RP107955	33°40'	1-006
24	O Screw in top of letterbox gone	13/1S194541	225°45'	3-5
24	O GI Nail gone	13/1S194541	324°39'45"	7-98
24	O Screw gone	13/1S194541	325°59'40"	22-74
25	O Nail gone	25/1S161185	280°10'10"	8-144
26	Screw		92°54'	6-706
27	Screw in Conc		27°16'	4-818
28	Screw on top of Conc wall		32°59'30"	6-411

[88°52'10" 7-014]

Corrections made 4/18/09 in accordance with  
Section 15 Land Title Act 1994 /  
Section 291 Land Act 1994  
See Dealing No.  
712627790  
Registrar of Titles

*m y harker*

P.M.L. 4/8/09



Scale 1:500 - Lengths are in Metres.

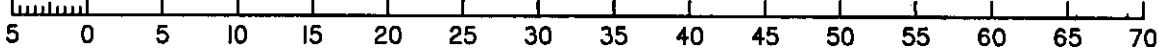

State copyright reserved.

Insert Plan Number **SP163172**

**LEVEL A**

Scale 1:300

**DIAGRAM B**

Scale 1:150



*Note: No walls exist between  
C-D, D-E, E-F, D-G & H-J.*

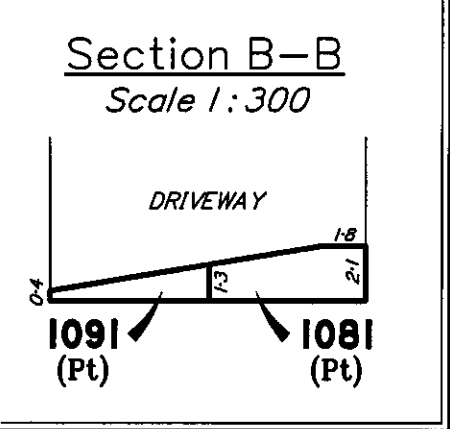
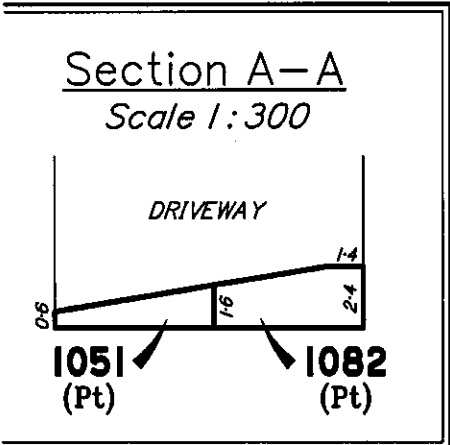
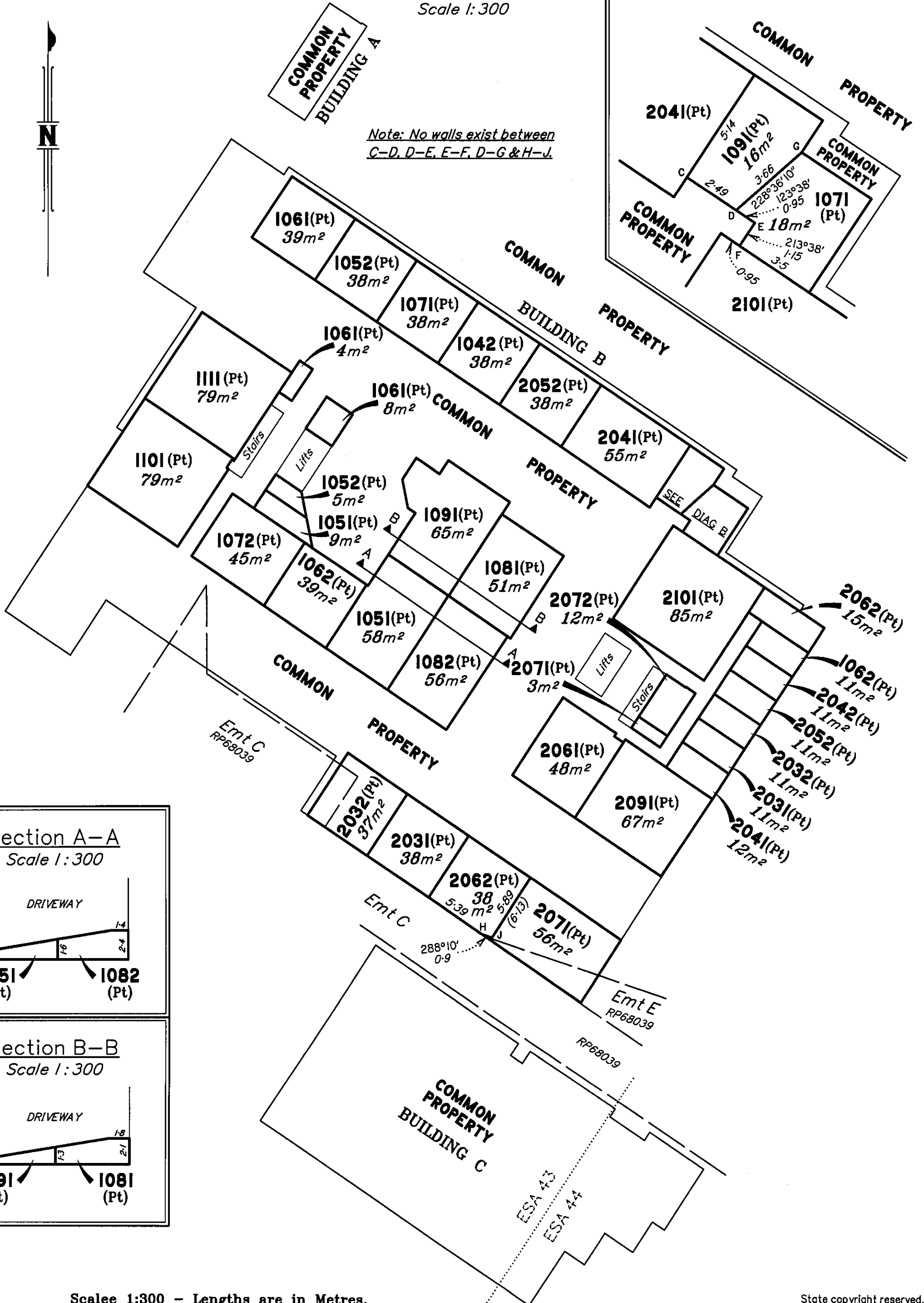

Scale 1:300 - Lengths are in Metres.

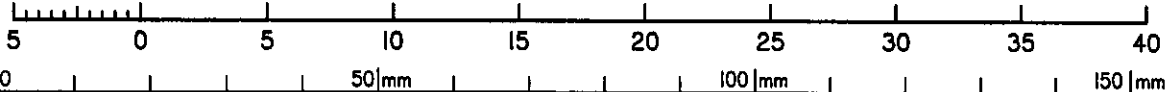

State copyright reserved.

Insert Plan Number **SP163172**

DL 1903-00-057 K 19030004



**LEVEL C**

Scale 1:300

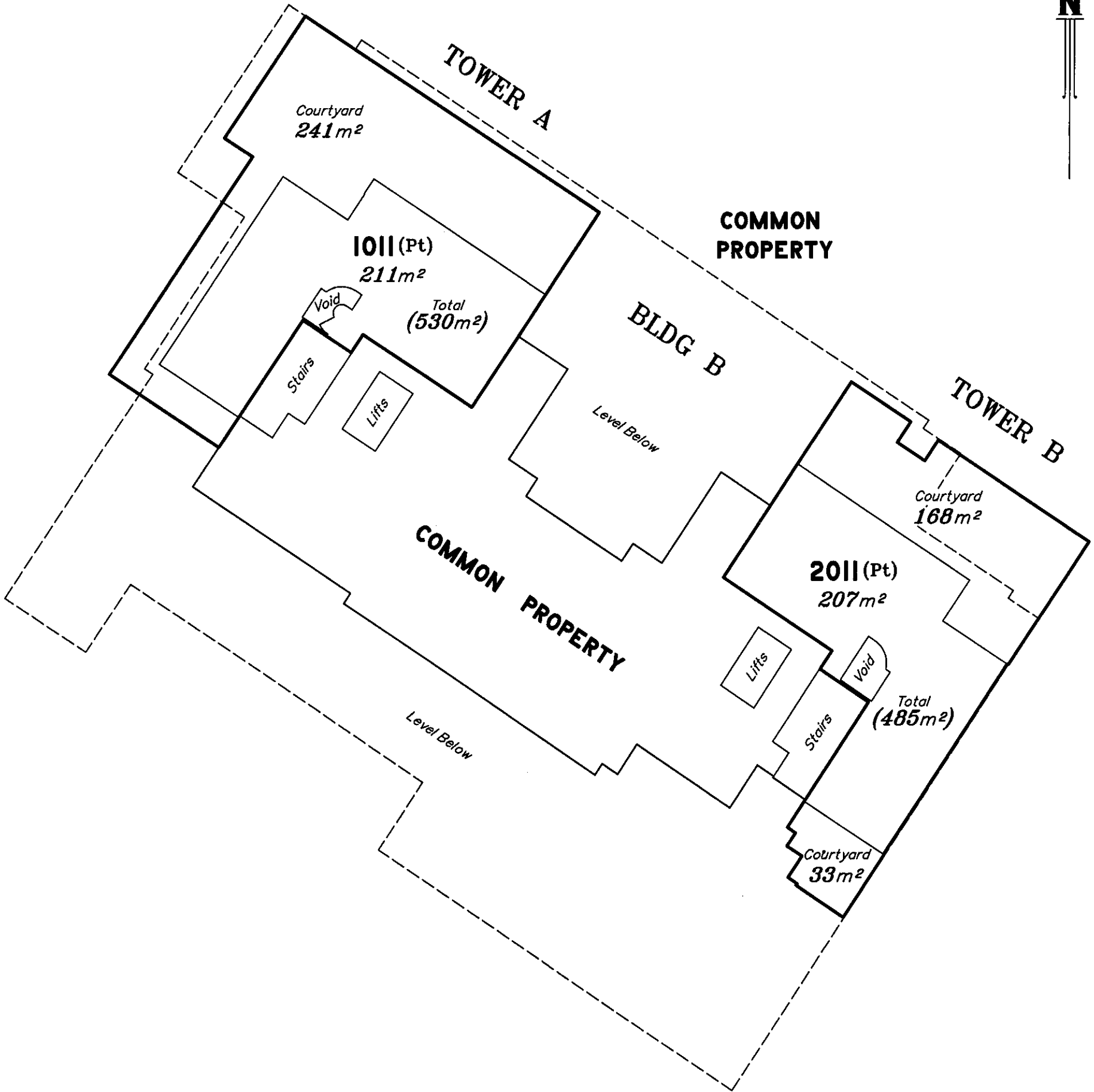

Scale 1:300 - Lengths are in Metres.

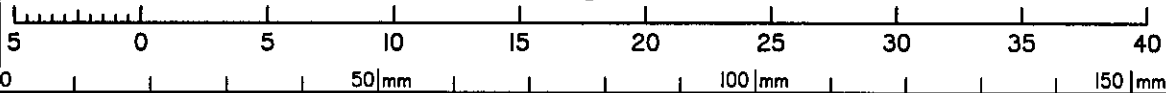

State copyright reserved.

Insert Plan Number **SP163172**

# LEVEL D

Scale 1:300

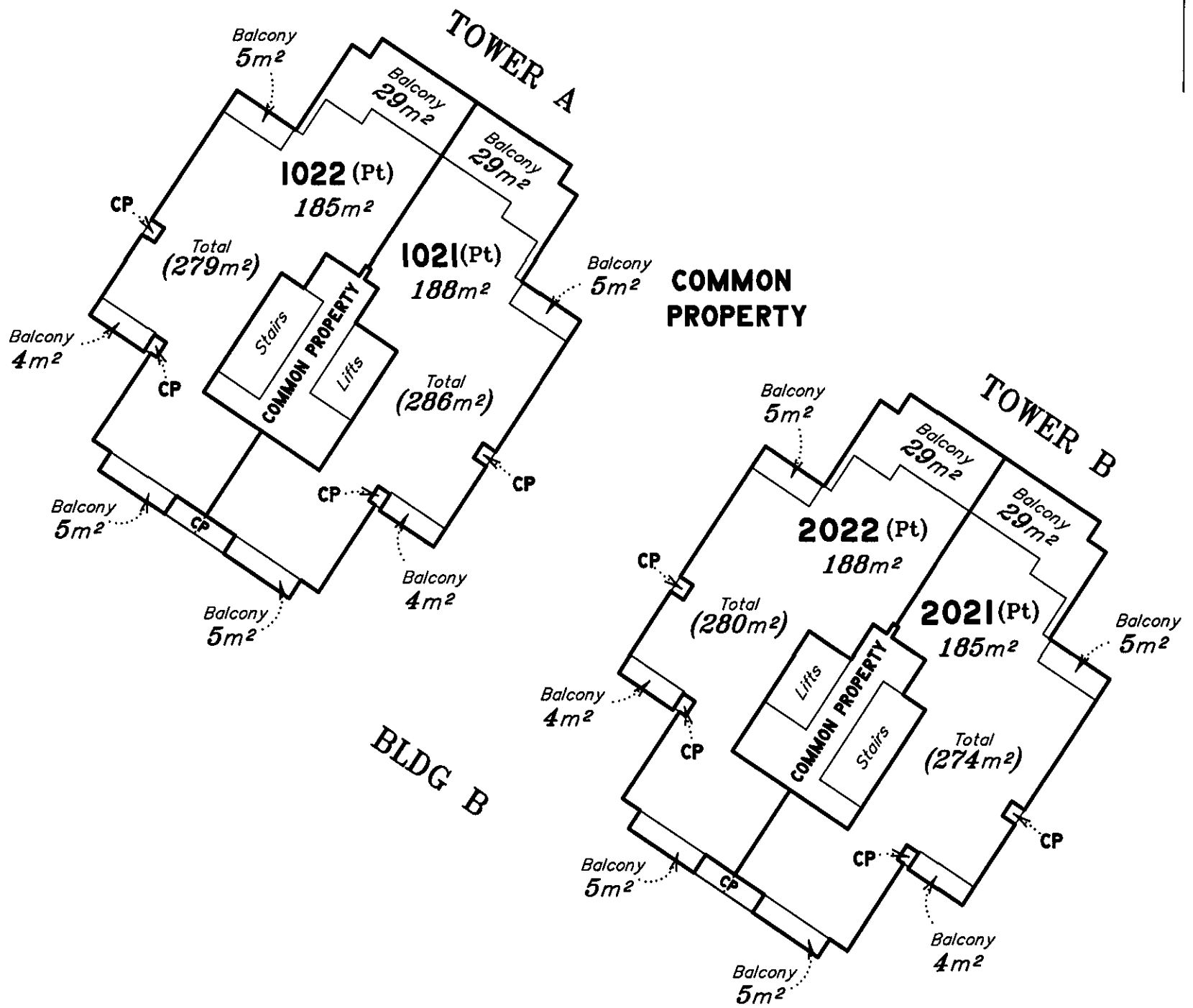

Scale 1:300 - Lengths are in Metres.

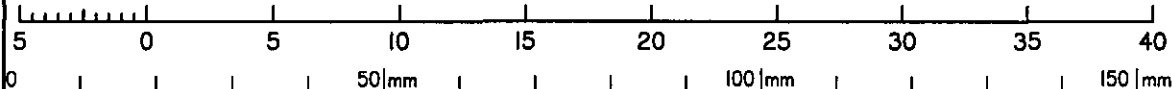

State copyright reserved.

Insert Plan Number **SP163172**

**LEVEL E**

Scale 1:300

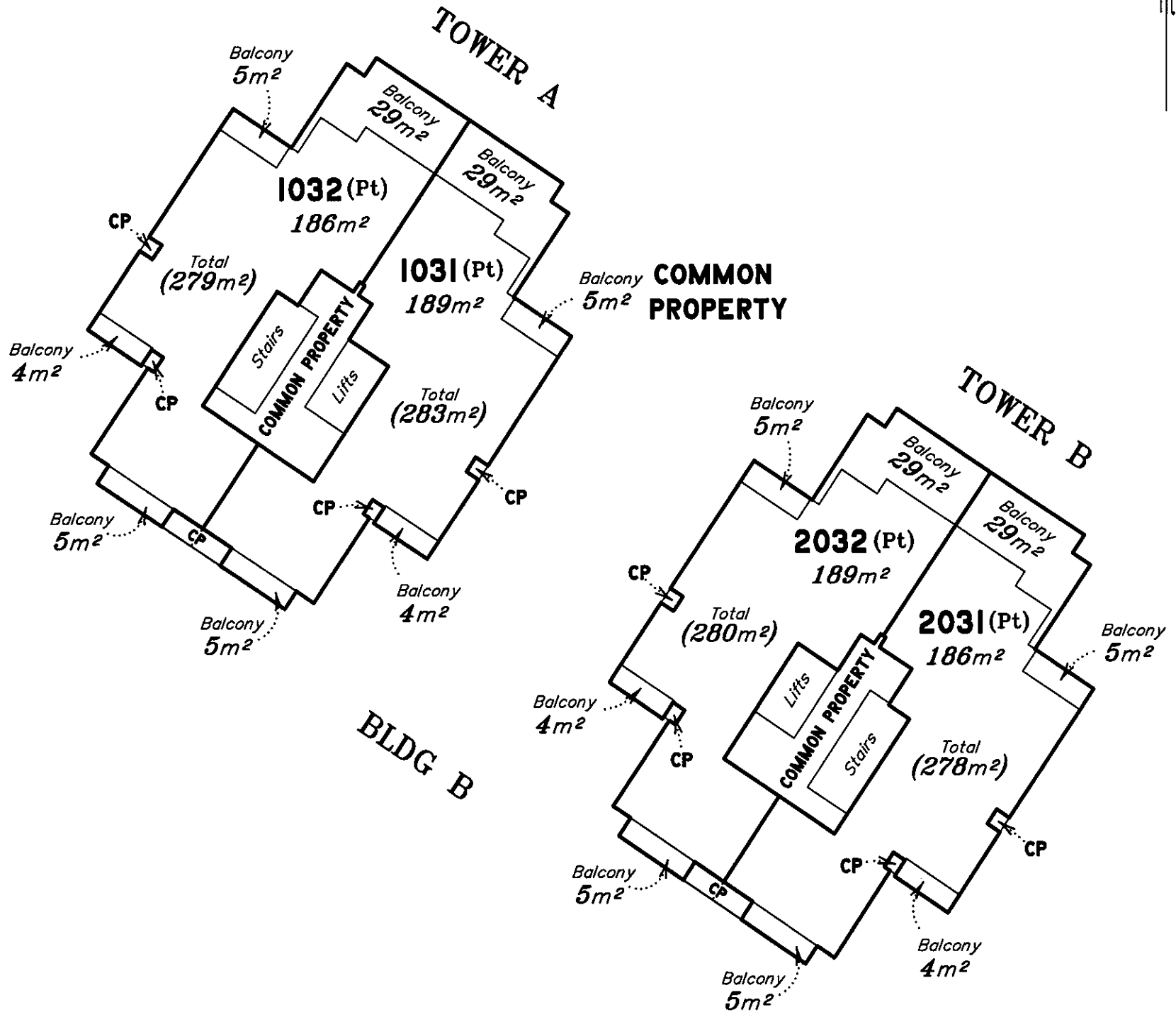

Scale 1:300 - Lengths are in Metres.

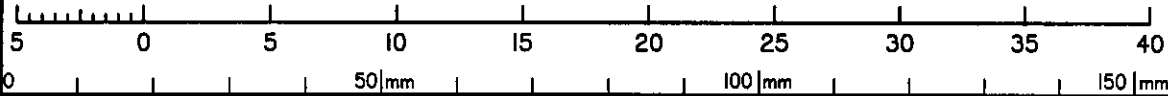

State copyright reserved.

Insert Plan Number **SP163172**



**LEVEL F**

Scale 1:300

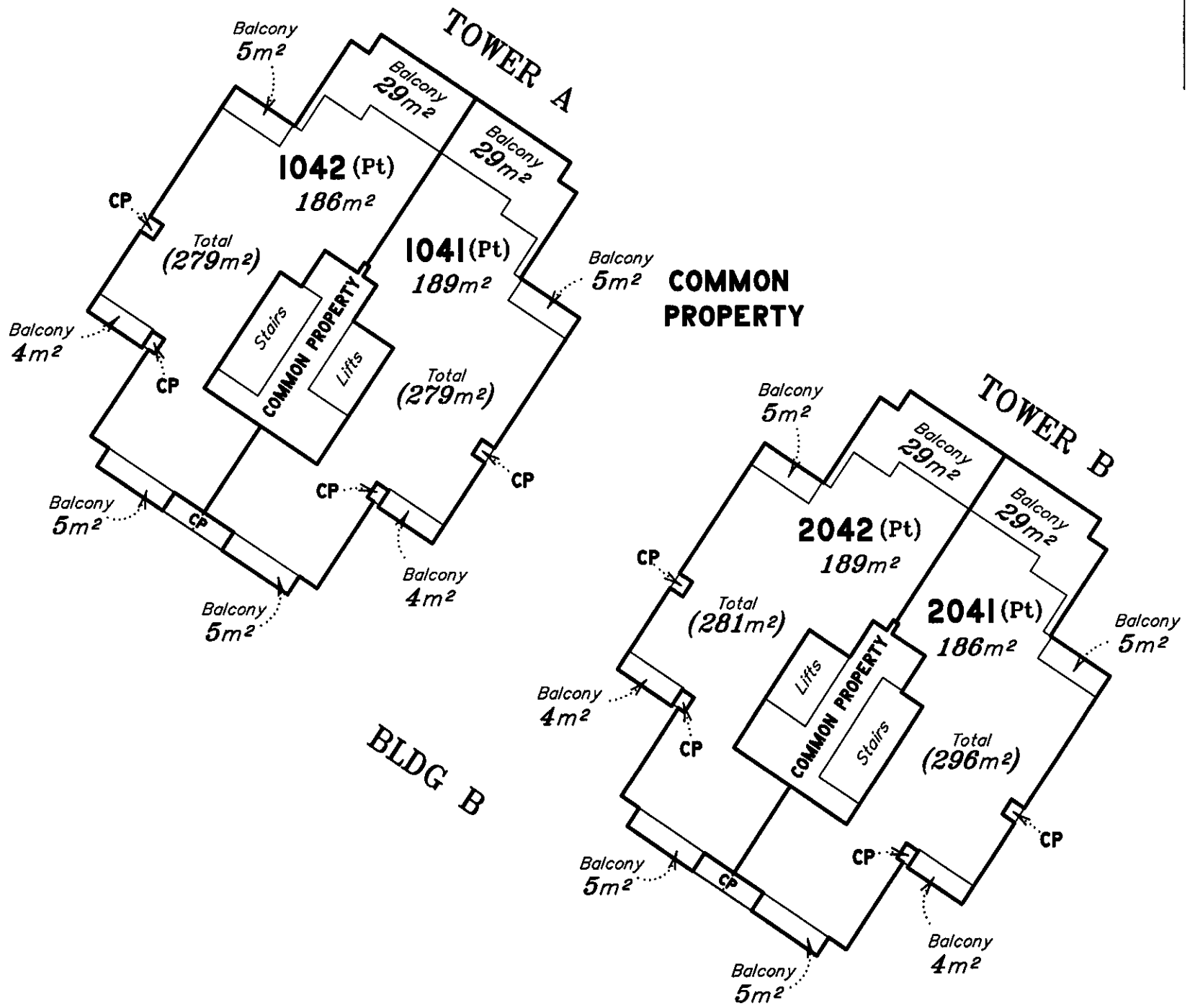

Scale 1:300 - Lengths are in Metres.

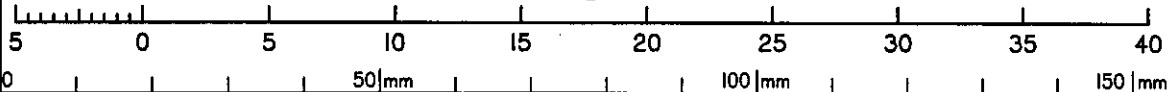

State copyright reserved.

Insert Plan Number **SP163172**

**LEVEL G**

Scale 1:300

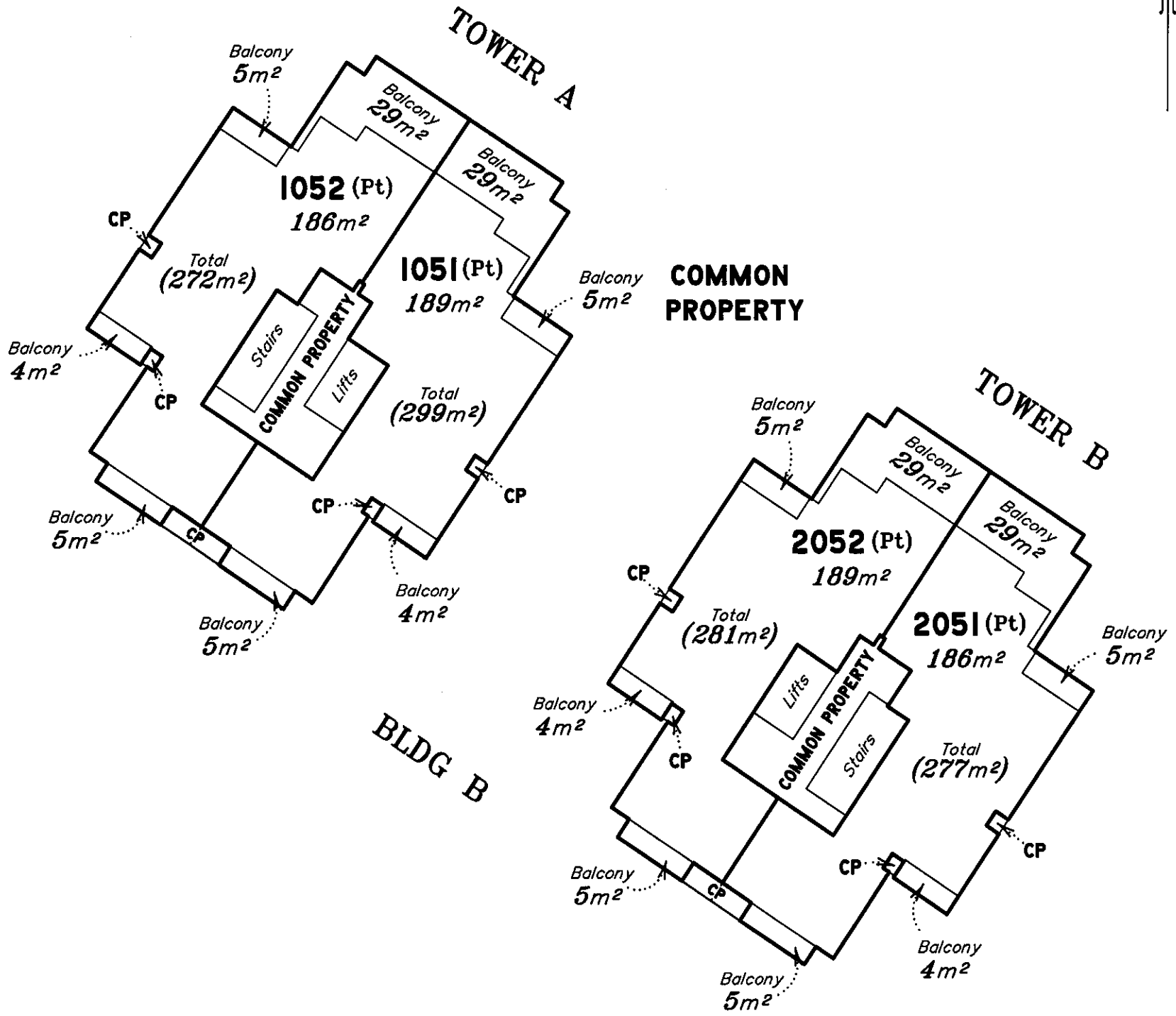

Scale 1:300 - Lengths are in Metres.

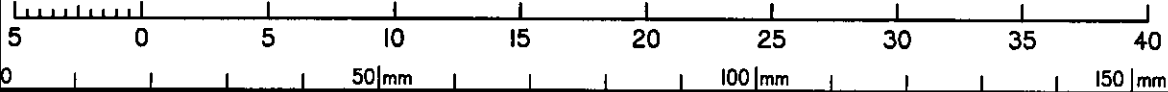

State copyright reserved.

Insert Plan Number **SP163172**





**LEVEL J**

Scale 1:300

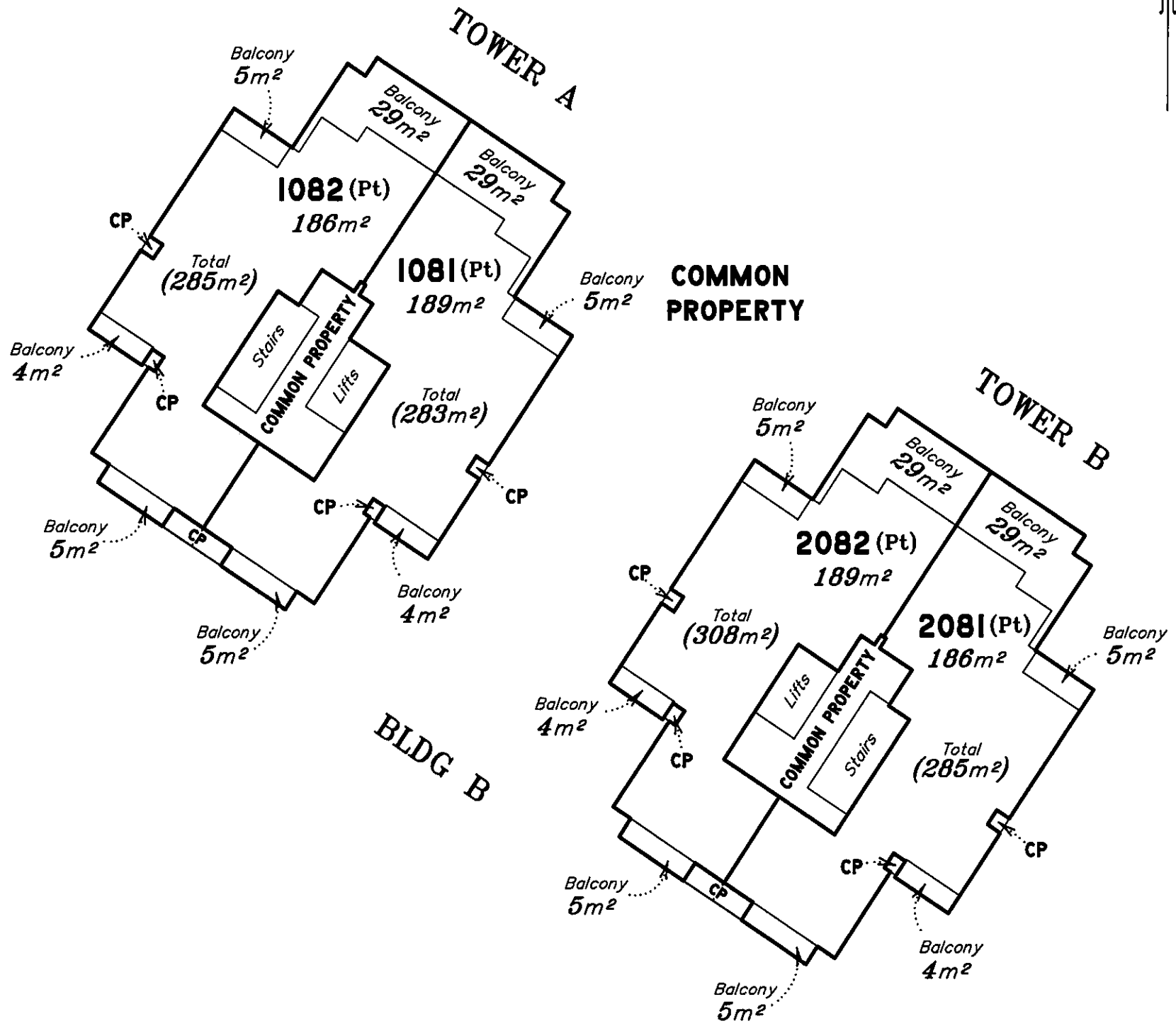

Scale 1:300 - Lengths are in Metres.

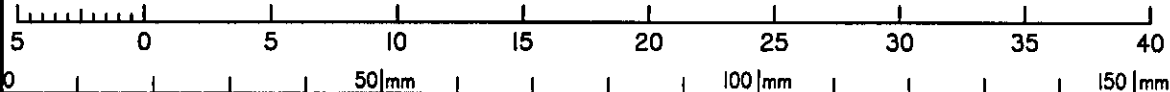

State copyright reserved.

Insert Plan Number **SP163172**

**LEVEL K**

Scale 1:300

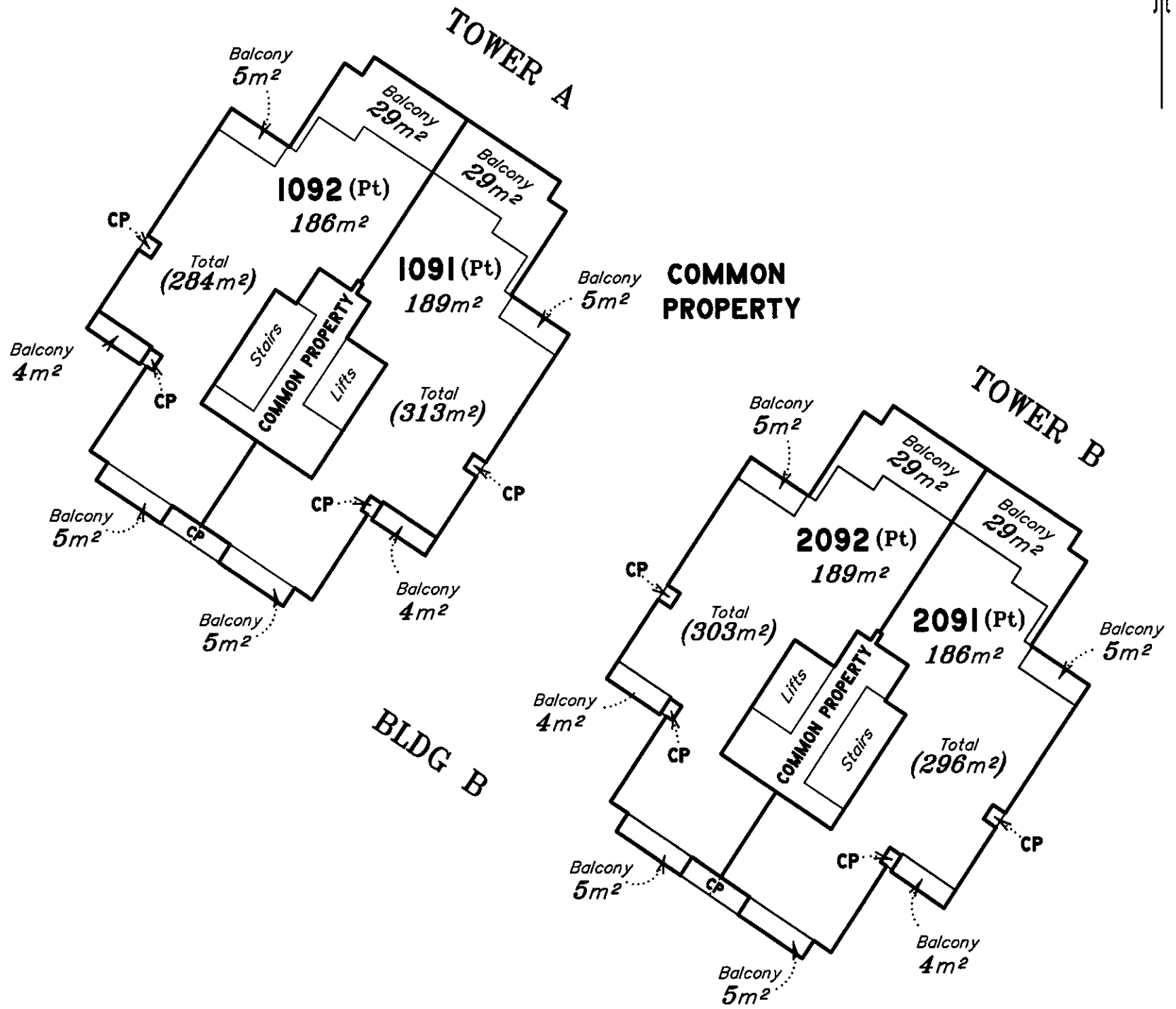

Scale 1:300 - Lengths are in Metres.

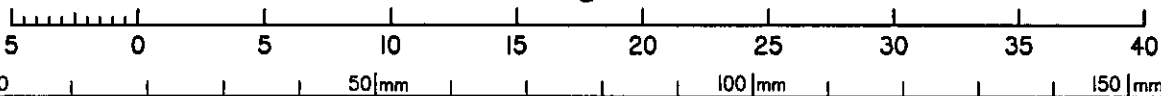

State copyright reserved.

Insert Plan Number **SP163172**

**LEVEL L**

Scale 1:300

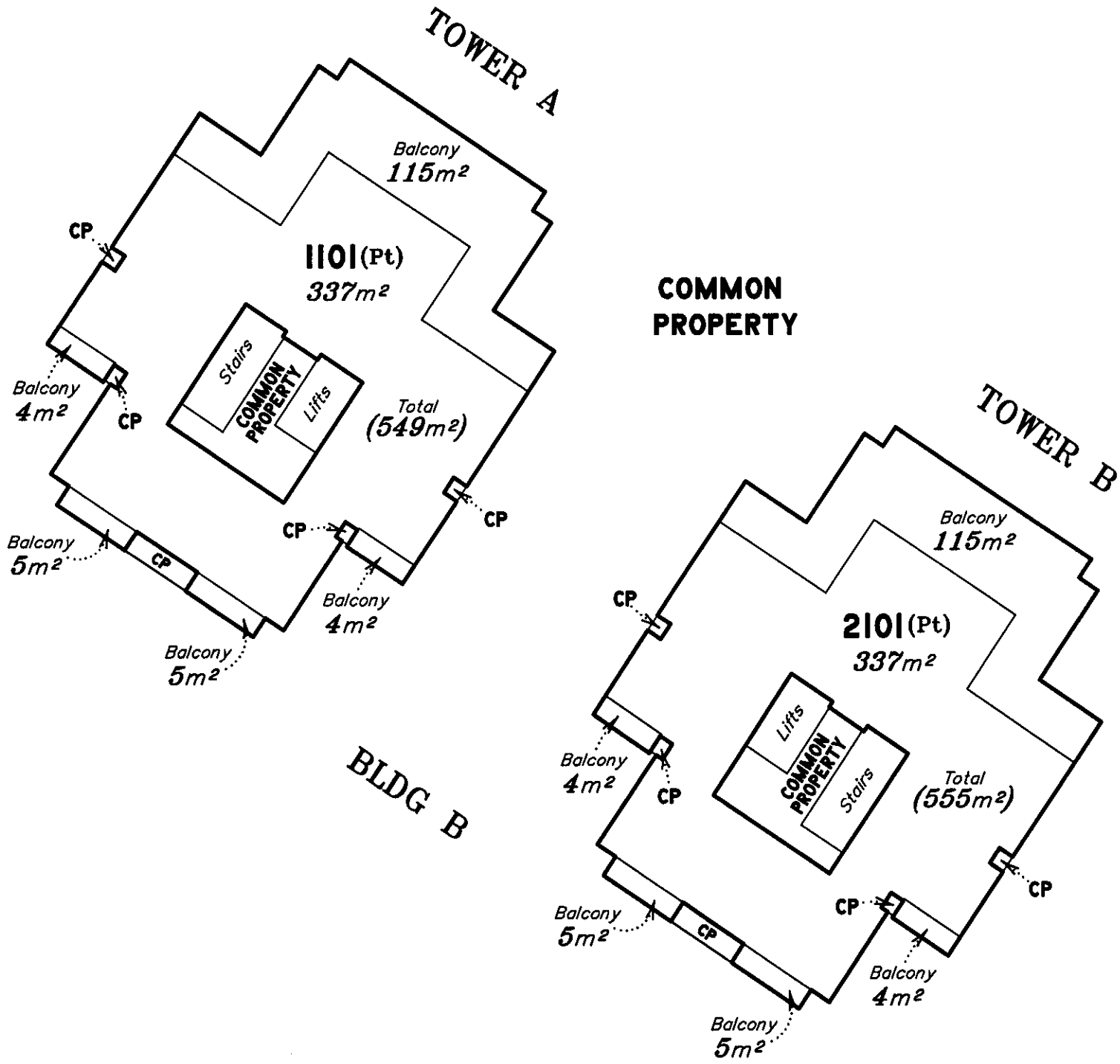

Scale 1:300 - Lengths are in Metres.



State copyright reserved.

Insert Plan Number **SP163172**

**LEVEL M**

Scale 1:300

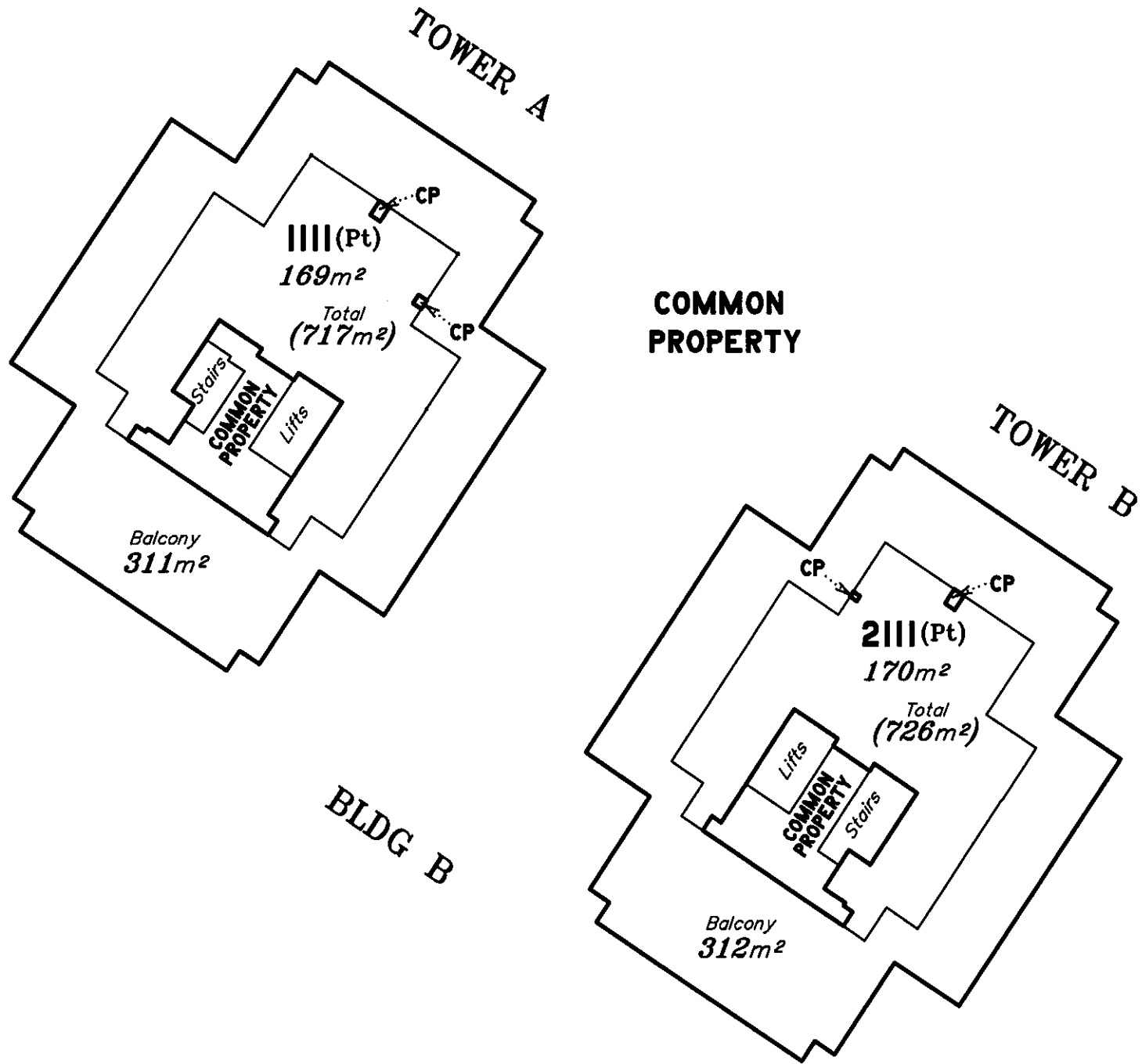

Scale 1:300 - Lengths are in Metres.



State copyright reserved.

Insert Plan Number **SP163172**



**LEVEL N**  
Scale 1:300

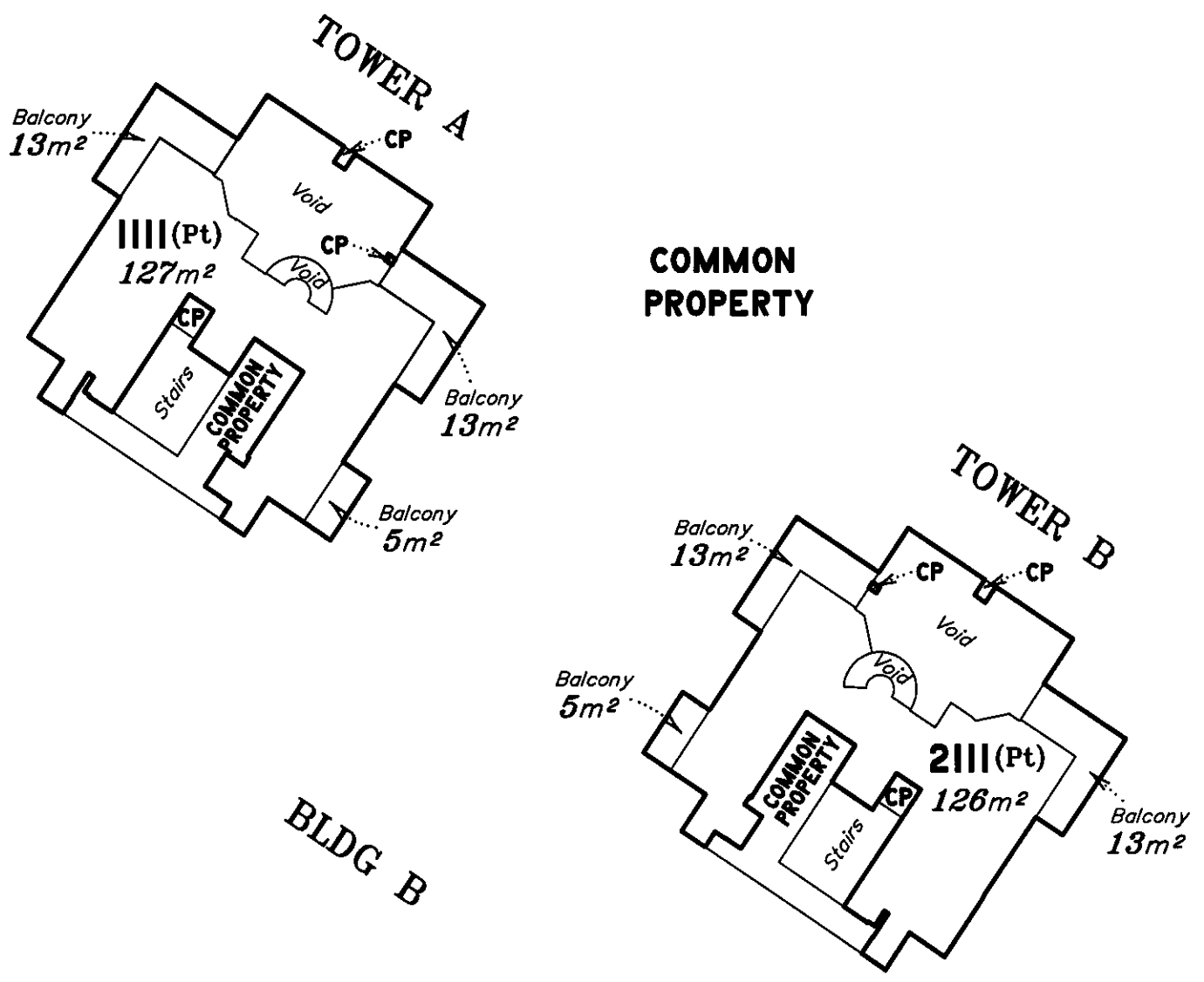

Scale 1:300 - Lengths are in Metres.



State copyright reserved.

Insert Plan Number **SP163172**

**LEVEL 0**

Scale 1:300

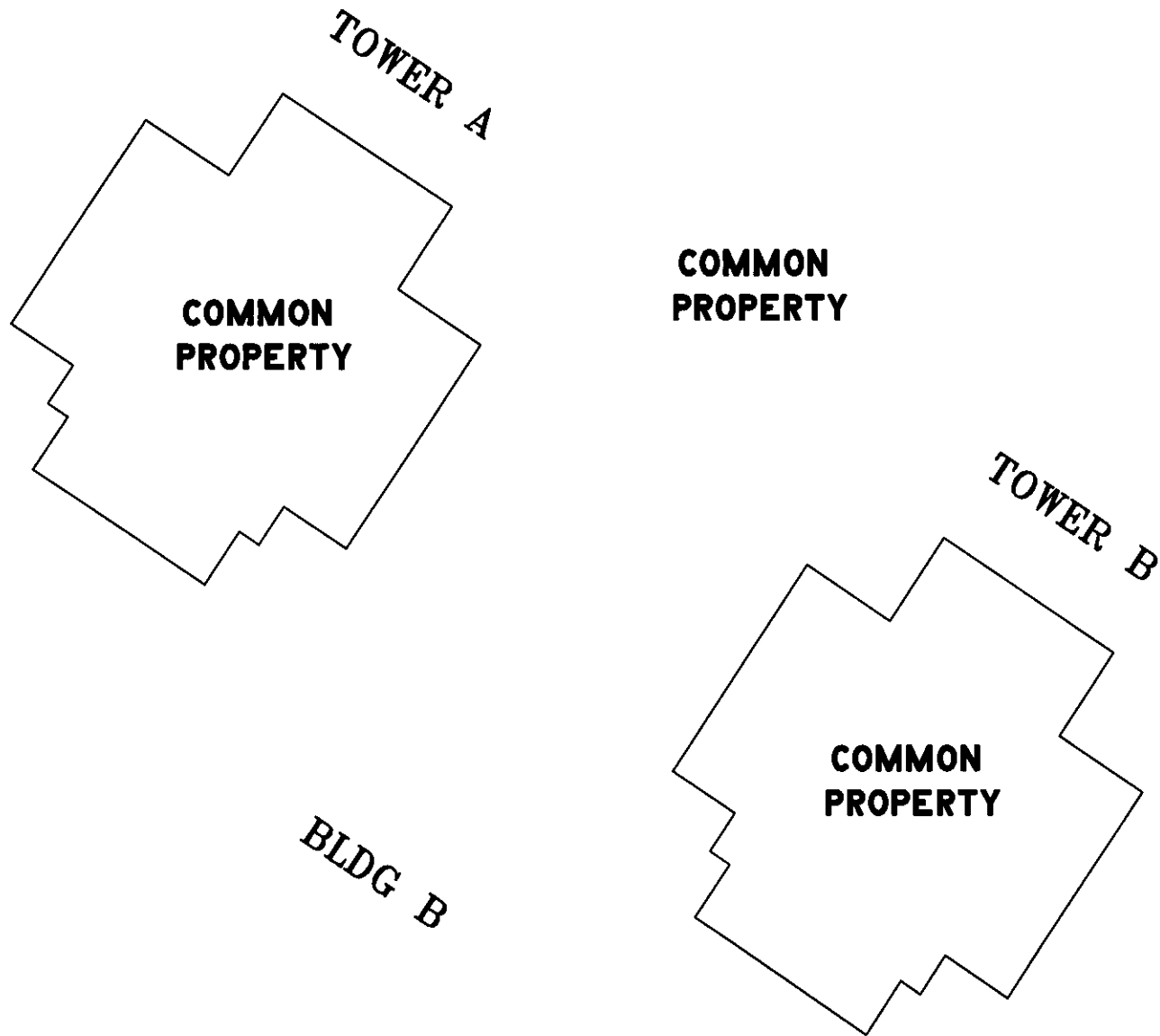

Scale 1:300 - Lengths are in Metres.



State copyright reserved.

Insert Plan Number **SP163172**